

AN ISO  
9001 : 2008  
COMPANY

Translate your dreams  
into a **magical** reality

**HART**<sup>TM</sup>  
for life time steel

architectural  
**Hardware**  
FITTINGS

## Delivering Versatile Elements of aesthetics

### company Profile

#### ABOUT US:-

ALFA is leading manufacturer of corrosive resistance high grade AISI 316/304 stainless steel architectural hardware fitting since last many year. Products are manufacturing under the brand name **HART**.

The product range portfolio has a wide range of products offered by us are demanded in the market to their features, design, polish and finish, dimensional accuracy, durability.

Our products are used in worldwide in different projects such as Commercial, Industrial, Domestic and International.

Our organisation is backed by experienced team members. Who helps in understanding the diverse requirement of the client and offering the products accordingly.

#### INFRASTRUCTURE:-

In our company well equipped modern machinery like as a VMC, CNC, Hydraulic banding machine, Power press, Buffing machine, Cutting machine, Hydraulic press, Manual batch grinder, Lath machine, Thread machine, Drill, Surface batch grinding machine and Round pipe grinding machine, Tig welding machine etc. To produce a better & bulk production. Our total production are "in-house".

#### QUALITY & MANAGEMENT:-

All of our products are manufacture under one roof following ISO 9001:2008 quality standards.

We manufacture these products by using superior quality raw material which is sources from the reliable vendors. Raw materials are tested on different physical and chemical parameter to ensures their quality.

We having modern machinery to makes process of converting raw materials into finished goods.

During the process we better take care of the products to be its best when process ends. We giving equal importance production expansion as well as pre & post services.

#### MISSION:-

Our mission is to provide high quality products with reasonable rate, best customer service and the product guarantee. We are trying to provide satisfaction to our each and every customer and dispatch as per commitment.

#### METHODOLOGY:-

We believe in strong research and development before we launch our products in market. We also gets the valuable opinion from Architectures and Interior designers for better look comfort and style of our product.

#### VISION:-

Over the years, our company has introduced high quality and latest product range for society to leave the competitors for behind in order to meet the set goal of company. We use constant changing as per market demand and client specified requirements.

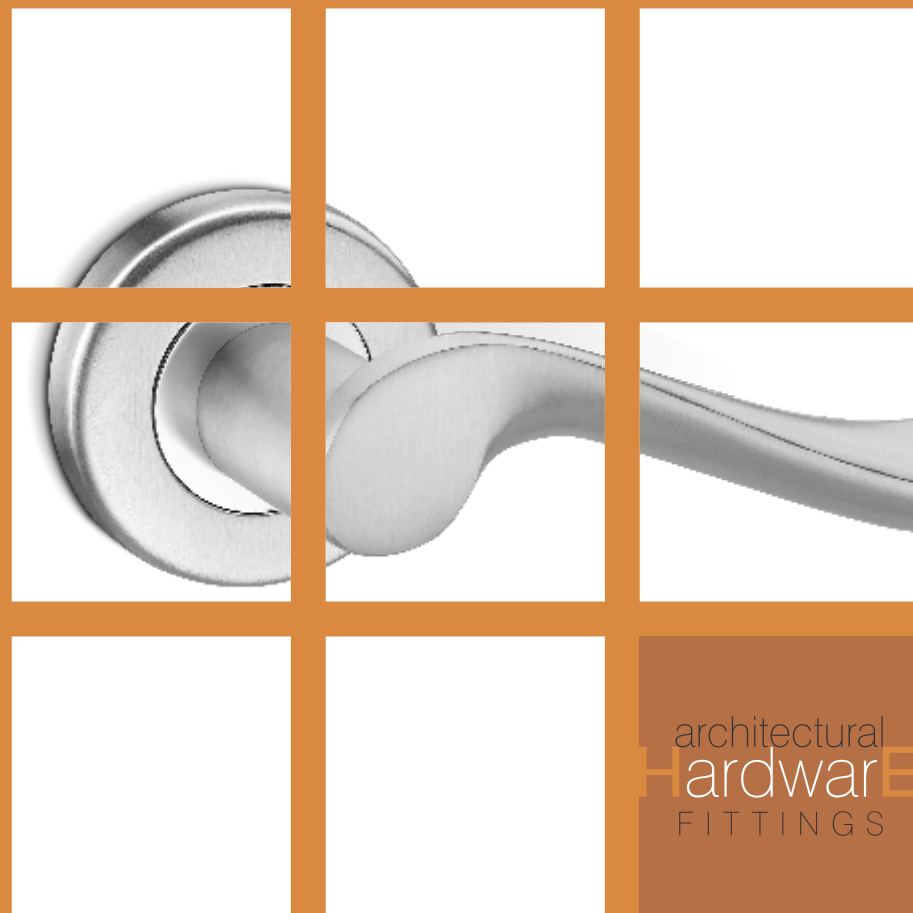

Time less designs and elegance for better life style and proper functionality.

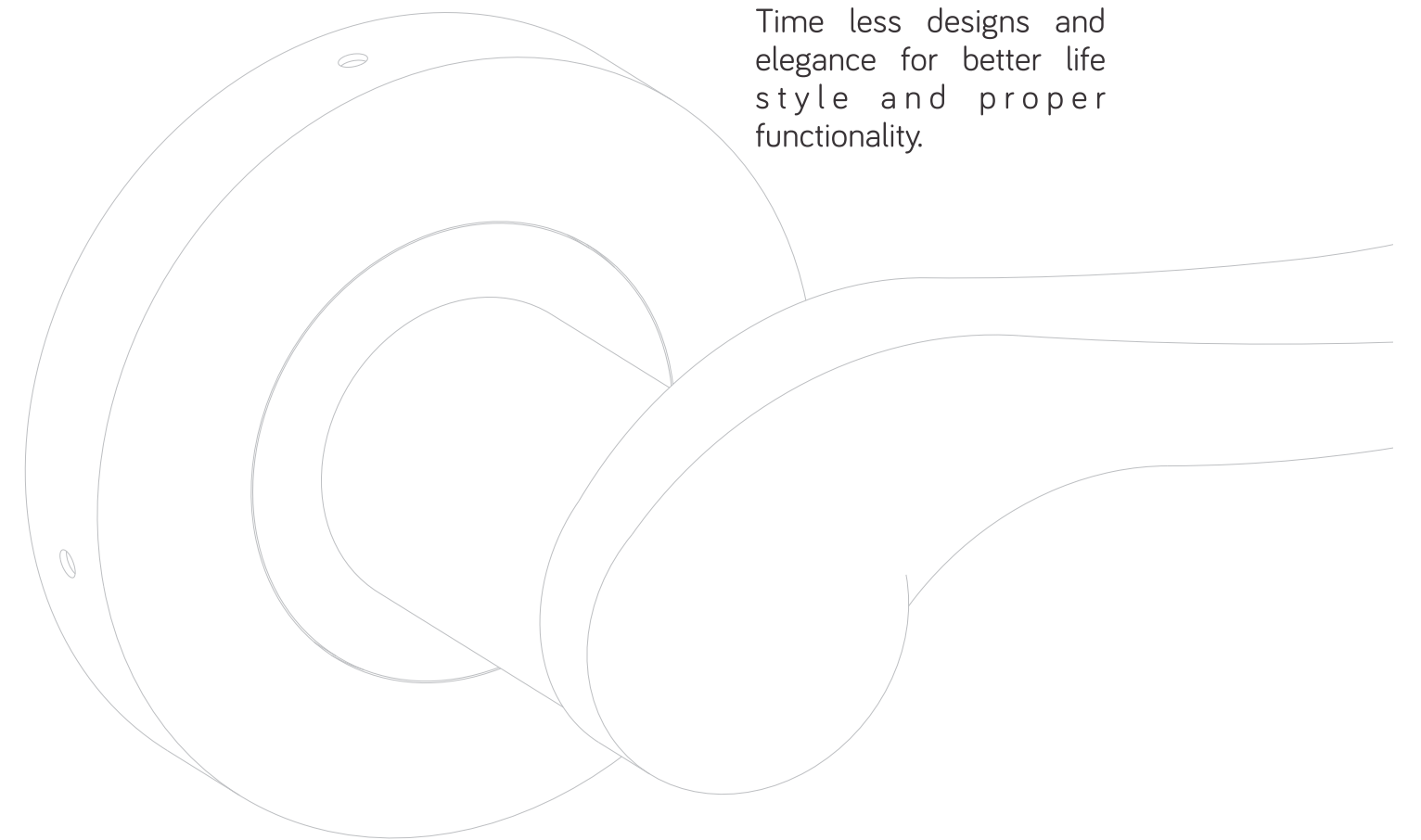

# MORTISE HANDLES

# MORTISE HANDLES

AN ISO 9001 : 2008 COMPANY



### AMH-01

Mortise handle 19mm & 22mm round pipe  
 Finish : Satin / Glossy  
 Material : Stainless steel 304 grade  
 (Also available in plate type mortise)



### AMH-05

Mortise handle 19mm round pipe & solid casted  
 Finish : Satin / Glossy  
 Material : Stainless steel 304 grade  
 (Also available in plate type mortise)

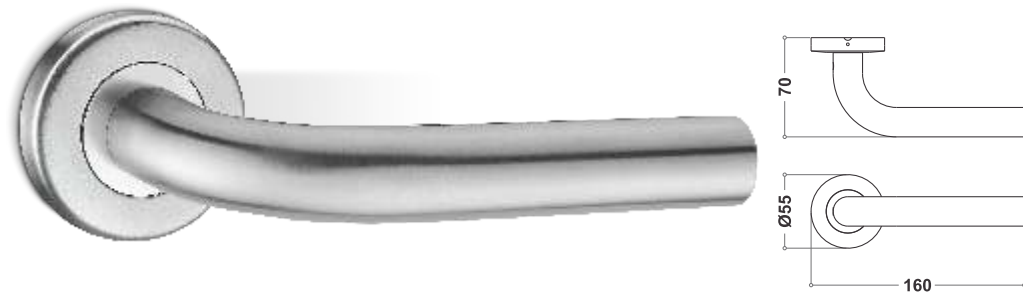

### AMH-02

Mortise handle 19mm & 22mm round pipe  
 Finish : Satin / Glossy  
 Material : Stainless steel 304 grade  
 (Also available in plate type mortise)



### AMH-06

Mortise handle solid casted  
 Finish : Satin / Glossy  
 Material : Stainless steel 304 grade  
 (Also available in plate type mortise)

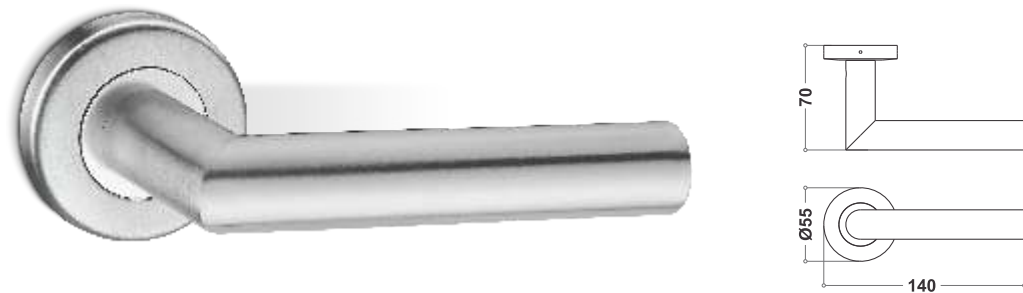

### AMH-03

Mortise handle 19mm & 22mm round pipe  
 Finish : Satin / Glossy  
 Material : Stainless steel 304 grade  
 (Also available in plate type mortise)

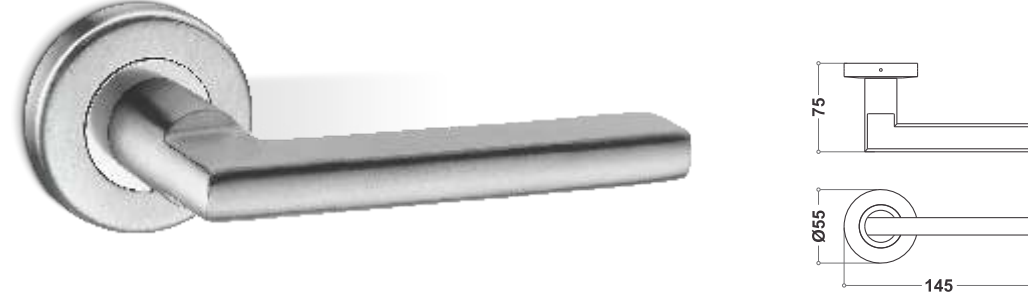

### AMH-07

Mortise handle solid casted  
 Finish : Satin / Glossy  
 Material : Stainless steel 304 grade  
 (Also available in plate type mortise)

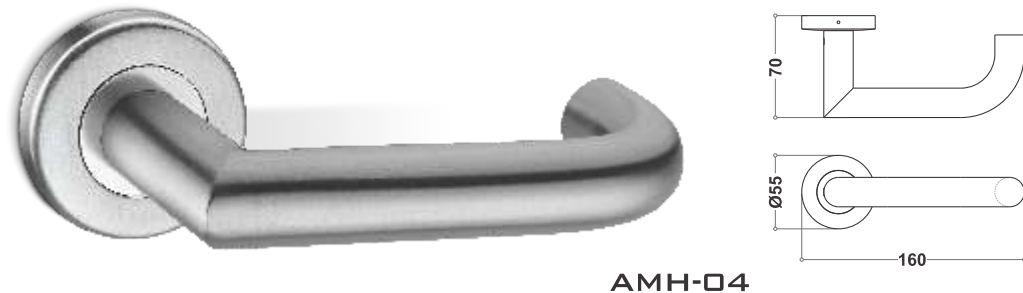

### AMH-04

Mortise handle 22mm round pipe  
 Finish : Satin / Glossy  
 Material : Stainless steel 304 grade  
 (Also available in plate type mortise)

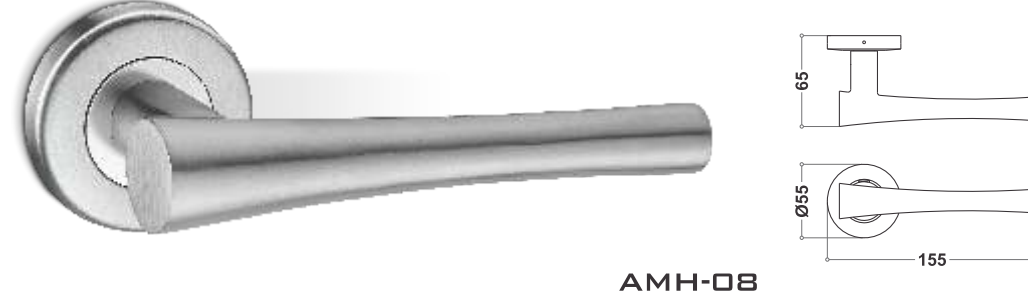

### AMH-08

Mortise handle solid casted  
 Finish : Satin / Glossy  
 Material : Stainless steel 304 grade  
 (Also available in plate type mortise)



# MORTISE HANDLES

AN ISO 9001 : 2008 COMPANY

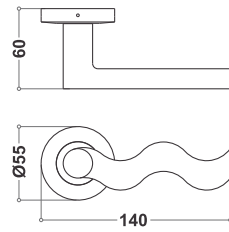

### AMH-09

Mortise handle solid casted  
 Finish : Satin / Glossy  
 Material : Stainless steel 304 grade  
 (Also available in plate type mortise)

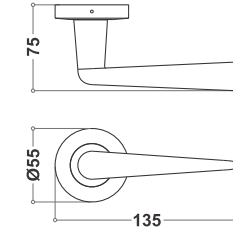

### AMH-13

Mortise handle solid casted  
 Finish : Satin / Glossy  
 Material : Stainless steel 304 grade  
 (Also available in plate type mortise)

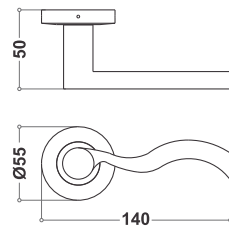
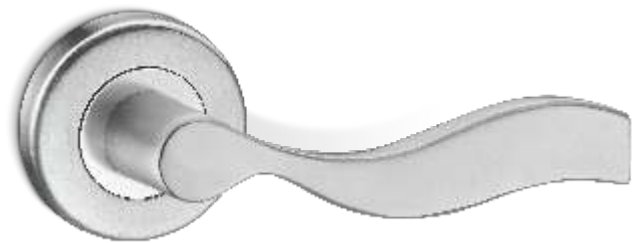

### AMH-10

Mortise handle solid casted  
 Finish : Satin / Glossy  
 Material : Stainless steel 304 grade  
 (Also available in plate type mortise)

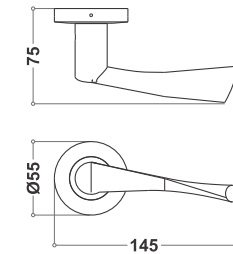
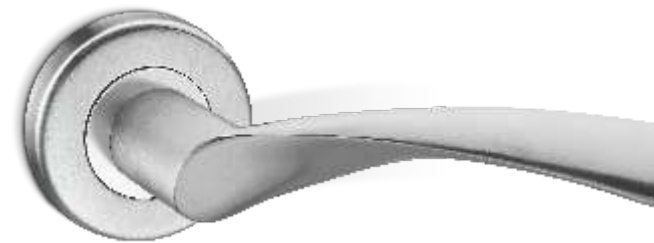

### AMH-14

Mortise handle solid casted  
 Finish : Satin / Glossy  
 Material : Stainless steel 304 grade  
 (Also available in plate type mortise)

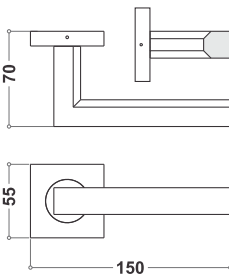
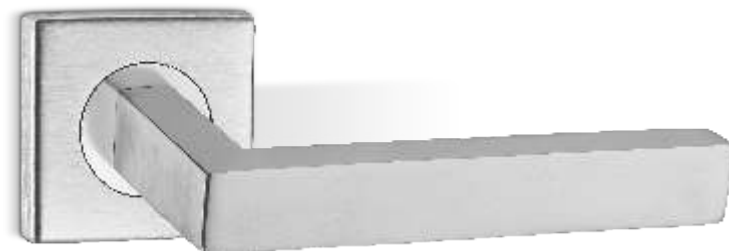

### AMH-11

Mortise handle solid casted  
 Finish : Satin / Glossy  
 Material : Stainless steel 304 grade  
 (Also available in plate type mortise)

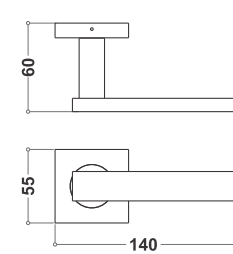
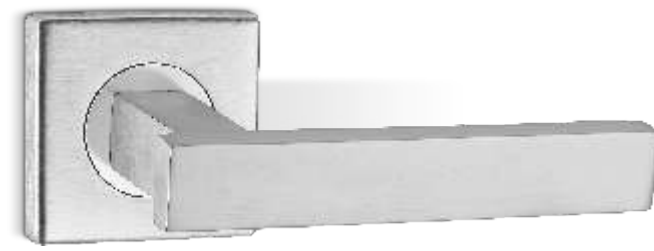

### AMH-15

Mortise handle solid  
 Finish : Satin / Glossy  
 Material : Stainless steel 304 grade  
 (Also available in plate type mortise)

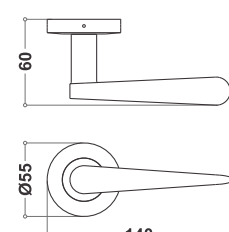
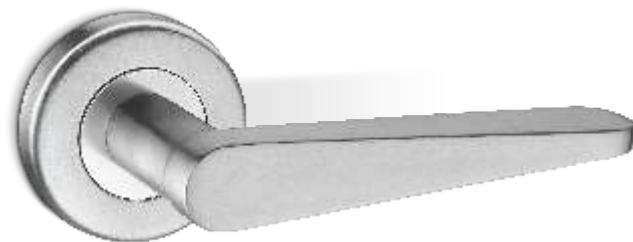

### AMH-12

Mortise handle solid casted  
 Finish : Satin / Glossy  
 Material : Stainless steel 304 grade  
 (Also available in plate type mortise)

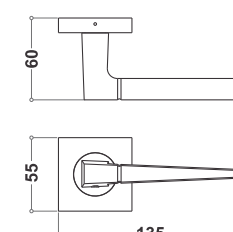
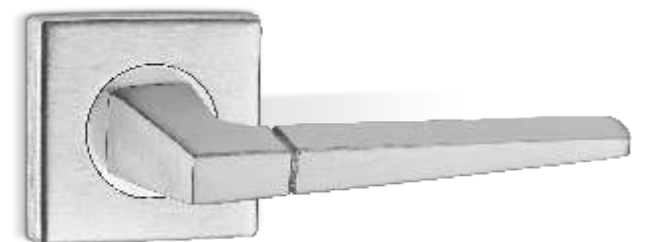

### AMH-16

Mortise handle solid casted  
 Finish : Satin / Glossy  
 Material : Stainless steel 304 grade  
 (Also available in plate type mortise)



# MORTISE HANDLES

AN ISO 9001 : 2008 COMPANY



## AMH-17

Mortise handle 20mm square pipe  
 Finish : Satin / Glossy  
 Material : Stainless steel 304 grade  
 (Also available in plate type mortise)



## AMH-21

Mortise handle 22mm round pipe  
 Finish : Satin / Glossy  
 Material : Stainless steel 304 grade  
 (Also available in plate type mortise)



## AMH-18

Mortise handle 19mm round pipe  
 Finish : Satin / Glossy  
 Material : Stainless steel 304 grade  
 (Also available in plate type mortise)



## AMH-22

Mortise handle solid  
 Finish : Satin / Glossy  
 Material : Stainless steel 304 grade  
 (Also available in plate type mortise)



## AMH-19

Mortise handle  
 Finish : Satin / Glossy  
 Material : Stainless steel 304 grade  
 (Also available in plate type mortise)



## AMH-23

Mortise handle solid casted  
 Finish : Satin / Glossy  
 Material : Stainless steel 304 grade  
 (Also available in plate type mortise)



## AMH-20

Mortise handle 22mm round pipe  
 Finish : Satin / Glossy  
 Material : Stainless steel 304 grade  
 (Also available in plate type mortise)



## AMH-24

Mortise handle solid casted & 19mm round pipe  
 Finish : Satin / Glossy  
 Material : Stainless steel 304 grade  
 (Also available in plate type mortise)



# MORTISE HANDLES

AN ISO 9001 : 2008 COMPANY



**AMH-25**  
 Mortise handle solid casted  
 Finish : Satin / Glossy  
 Material : Stainless steel 304 grade  
 (Also available in plate type mortise)



**AMH-26**  
 Mortise handle solid casted  
 Finish : Satin / Glossy  
 Material : Stainless steel 304 grade  
 (Also available in plate type mortise)



**AMH-27**  
 Mortise handle solid casted  
 Finish : Satin / Glossy  
 Material : Stainless steel 304 grade  
 (Also available in plate type mortise)



**AMH-28**  
 Mortise handle solid & 20mm square pipe  
 Finish : Satin / Glossy  
 Material : Stainless steel 304 grade  
 (Also available in plate type mortise)



**AMH-29**  
 Mortise handle solid  
 Finish : Satin / Glossy  
 Material : Stainless steel 304 grade  
 (Also available in plate type mortise)

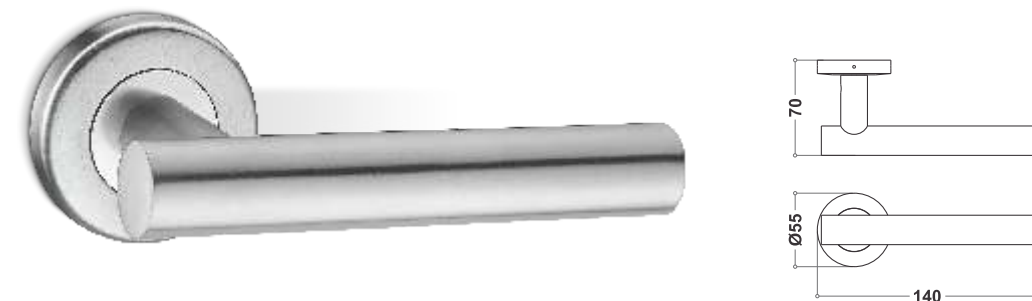

**AMH-30**  
 Mortise handle 22mm round pipe  
 Finish : Satin / Glossy  
 Material : Stainless steel 304 grade  
 (Also available in plate type mortise)



**AMH-31**  
 Mortise handle 22mm round pipe  
 Finish : Satin / Glossy  
 Material : Stainless steel 304 grade  
 (Also available in plate type mortise)



**AMH-32**  
 Mortise handle solid  
 Finish : Satin / Glossy  
 Material : Stainless steel 304 grade  
 (Also available in plate type mortise)



# MORTISE HANDLES

AN ISO 9001 : 2008 COMPANY



## AMH-33

Mortise handle solid casted  
 Finish : Satin / Glossy  
 Material : Stainless steel 304 grade  
 (Also available in plate type mortise)



## AMH-37

Mortise handle solid casted  
 Finish : Satin / Glossy  
 Material : Stainless steel 304 grade  
 (Also available in plate type mortise)



## AMH-34

Mortise handle solid casted  
 Finish : Satin / Glossy  
 Material : Stainless steel 304 grade  
 (Also available in plate type mortise)



## AMH-38

Mortise handle solid casted  
 Finish : Satin / Glossy  
 Material : Stainless steel 304 grade  
 (Also available in plate type mortise)



## AMH-35

Mortise handle solid casted  
 Finish : Satin / Glossy  
 Material : Stainless steel 304 grade  
 (Also available in plate type mortise)



## AMH-39

Mortise handle solid casted  
 Finish : Satin / Glossy  
 Material : Stainless steel 304 grade  
 (Also available in plate type mortise)

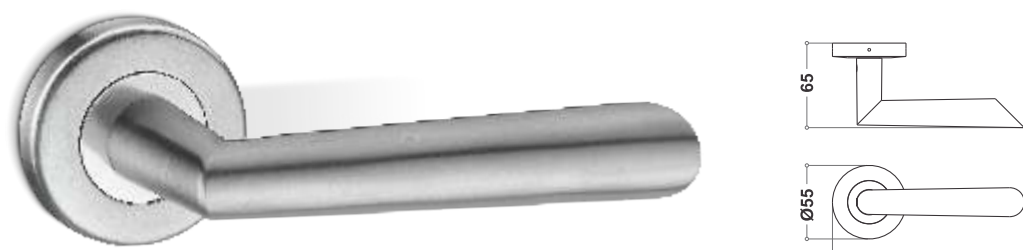

## AMH-36

Mortise handle solid casted  
 Finish : Satin / Glossy  
 Material : Stainless steel 304 grade  
 (Also available in plate type mortise)



## AMH-40

Mortise handle solid casted  
 Finish : Satin / Glossy  
 Material : Stainless steel 304 grade  
 (Also available in plate type mortise)





# MORTISE HANDLES

AN ISO 9001 : 2008 COMPANY

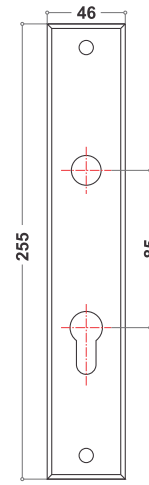

### AMH-01-P

Mortise handle with plate solid casted  
 Finish : Satin / Glossy  
 Material : Stainless steel 304 grade

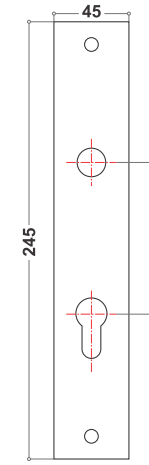

### AMH-03-P

Mortise handle with plate  
 Finish : Satin / Glossy  
 Material : Stainless steel 304 grade

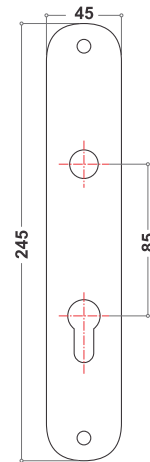

### AMH-02-P

Mortise handle with plate  
 Finish : Satin / Glossy  
 Material : Stainless steel 304 grade

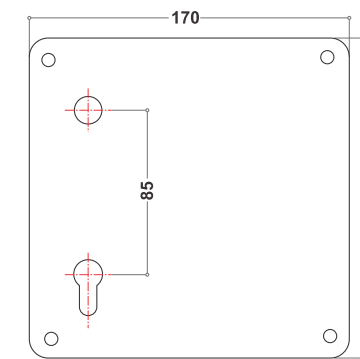

### AMH-04-P

Mortise handle with plate  
 Finish : Satin / Glossy  
 Material : Stainless steel 304 grade



# MORTISE LOCK BODY



**AML-01**  
Mortise lock body with strike plate for wood door applied with mortise & cylinder  
Finish : Satin / Black



**AML-02**  
Mortise dead lock with strike plate for wood door applied with cylinder  
Finish : Satin / Black



**AML-03**  
Mortise baby latch with strike plate for wood door applied with cylinder  
Finish : Satin / Black



**AKH-01**  
Round key hole  
Finish : Satin / Glossy  
Material : Stainless steel 304 grade



**AKH-02**  
Square key hole  
Finish : Satin / Glossy  
Material : Stainless steel 304 grade



**AMC-01**  
Both side key cylinder with key



**AMC-02**  
One side key & one side knob cylinder with key



**AMC-03**  
One side knob & one side screwdriver part



**AMC-04**  
Half cylinder one side knob only

At **HART**, we constantly endeavor to raise the bar for excellence – be it in our designs, manufacturing or consumer relationship. We are grateful to have you as our valued client, associate and well-wisher and in order to meet your expectations – or even surpass it – we urge you to share your views with us at your convenience, so that we can improve upon perfection. We reiterate our commitment to deliver the most versatile range of architectural hardware fittings that translate your dream into a magical reality.



Mfg. & Mktd by

**ALFA** Industries

Rajkot (Gujarat)

🌐 [www.alfahardware.com](http://www.alfahardware.com)

✉ [info@alfahardware.com](mailto:info@alfahardware.com)